

LEGENDA:

- ZONA STUDIATA
- LOT 1:** drum privat pentru acces
nr. cad. 64040, proprietari: Hidisan Andrei Mihai si Hidisan Raluca Liliana (cota 1/2)
Miclea Mihai (cota 1/2)
S = 400 mp + 21 mp (cedati de la LOTUL 2) + 21 mp (cedati de la LOTUL 3) = **442 mp**
- LOT 2:** teren arabil, particular, nr. cad. 64041, proprietar: Miclea Mihai
S = 900 mp - 21 mp (cedati pentru drum LOT 1) = **879 mp**
- LOT 3:** teren arabil, particular, nr. cad. 64042, S = 900 mp, proprietar: Hidisan Andrei Mihai si Hidisan Raluca Liliana
S = 900 mp - 21 mp (cedati pentru drum LOT 1) = **879 mp**
- SUPRAFATA DE TEREN CONSTRUIBILA
- SUPRAFATA DE TEREN CEDATA DRUMULUI DE ACCES (LOTULUI 1, nr. cad. 64040)
- CONSTRUCTII VECINE EXISTENTE
- DRUM - strada Curcubeului
- RECIPIENT DE COLECTARE SELECTIVA A DESEURILOR MENAJERE
- LOCUINTA FAMILIALA Sp +P
- ANEXE P

Plansa 5 - Mobilare urbanistica

SECTIUNEA TRANSVERSALA A-A
DRUM DE ACCES (LOT 1)

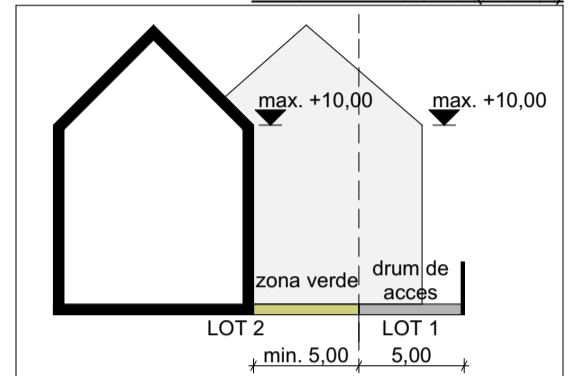

Retrageri minime pentru LOT 2 SI LOT 3:
- 5,00 m: fata de drumul de acces (LOT 1)
- 2,00 m: fata de terenurile arabile

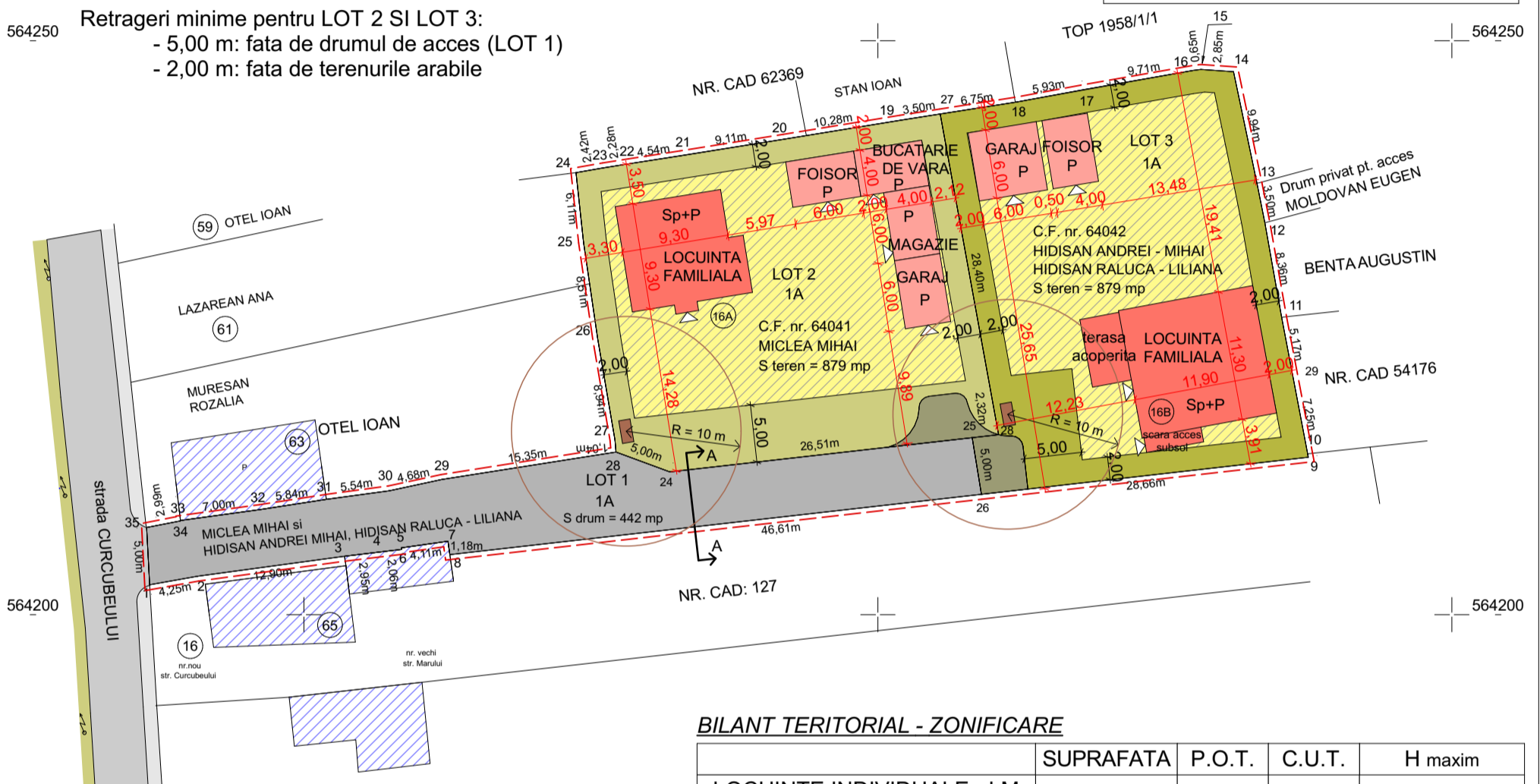

BILANT TERITORIAL - ZONIFICARE

	SUPRAFATA	P.O.T.	C.U.T.	H maxim
LOCUINTE INDIVIDUALE - LM	1758 mp	35 %	0,5	S+P+1E+M/E (max. 10m la streasina)
CURTI CONSTRUCTII				
CIRCULATII - C	442 mp			
DRUM DE ACCES				

Parcela (LOT1)

Nr. Pct.	Coordonate pct.de contur		Lungimi laterale D(i,i+1)
	X [m]	Y [m]	
35	564207.591	407686.299	2.99
34	564208.165	407689.238	0.04
33	564208.202	407689.243	7.00
32	564209.154	407696.180	5.84
31	564210.045	407701.956	5.54
30	564210.791	407707.443	4.68
29	564211.776	407712.018	15.35
28	564214.164	407727.186	5.00
24	564212.434	407731.875	26.51
25	564215.416	407758.215	5.00
26	564210.482	407759.020	46.61
8	564205.228	407712.710	1.18
7	564206.394	407712.546	4.11
6	564205.817	407708.479	0.14
5	564205.683	407708.509	2.06
4	564205.437	407706.461	2.95
3	564205.085	407703.528	12.90
2	564203.346	407690.741	4.25
1	564202.601	407686.561	5.00

S (LOT1)=400.060mp P=157.15m

Parcela (LOT2)

Nr. Pct.	Coordonate pct.de contur		Lungimi laterale D(i,i+1)
	X [m]	Y [m]	
24	564212.434	407731.875	5.00
28	564214.164	407727.186	1.04
27	564215.202	407727.098	8.94
26	564224.011	407725.594	8.51
25	564232.434	407724.358	6.11
24	564238.505	407723.702	2.42
23	564238.926	407726.088	2.28
22	564239.281	407728.338	4.54
21	564239.975	407732.829	9.11
20	564241.417	407741.827	10.28
19	564243.075	407751.971	3.50
27	564243.616	407755.429	28.40
28	564215.676	407760.517	2.32
25	564215.416	407758.215	26.51

S (LOT2)=899.919mp P=118.96m

Parcela (LOT3)

Nr. Pct.	Coordonate pct.de contur		Lungimi laterale D(i,i+1)
	X [m]	Y [m]	
9	564213.712	407787.495	28.66
26	564210.482	407759.020	5.00
25	564215.416	407758.215	2.32
28	564215.676	407760.517	28.40
27	564243.616	407755.429	6.75
18	564244.660	407762.101	5.93
17	564245.736	407767.929	9.71
16	564247.415	407777.490	0.65
15	564247.496	407778.139	2.85
14	564247.300	407780.980	9.94
13	564237.572	407783.025	3.50
12	564234.140	407783.710	8.36
11	564225.909	407785.170	5.17
29	564220.834	407786.138	7.25

S (LOT3)=899.971mp P=124.48m

SC DARHCAD PROIECT SRL

C.U.I. 35351284 J 12 / 3852 / 22.12.2015
ORDINUL ARHITECTILOR DIN ROMANIA NR 3643
SEDIUL :TURDA , str. AGRICULTURII nr 24A , tel 0722589921
PUNCT DE LUCRU :TURDA str. DR. I. RATIU nr 18-22 ap 14

DarhCAD

SEF PROIECT

PROIECTARE URBANISM

DESENAT

arh. DANIELA DUMITRIU

arh. st. PAULA PETAC

arh. st. PAULA PETAC

SCARA

1:500

DATA

29.07.2019

BENEFICIAR:
HIDISAN ANDREI MIHAI si HIDISAN RALUCA LILIANA
MICLEA MIHAI

INVESTIȚIA:
P.U.Z. - ZONA REZIDENTIALA

PLANȚA:
MOBILARE URBANA

AMPLASAMENT:
TURDA, str. CURCUBEULUI, nr. 16A si 16B

NR. PROIECT:
29

FAZA:
P.U.Z.

PLANSA NR.:
U.05